

$$\begin{array}{r} 100 \\ 6.08 \\ \hline 106.08 \\ 100 \\ 6.08 \\ \hline 106.08 \end{array}$$

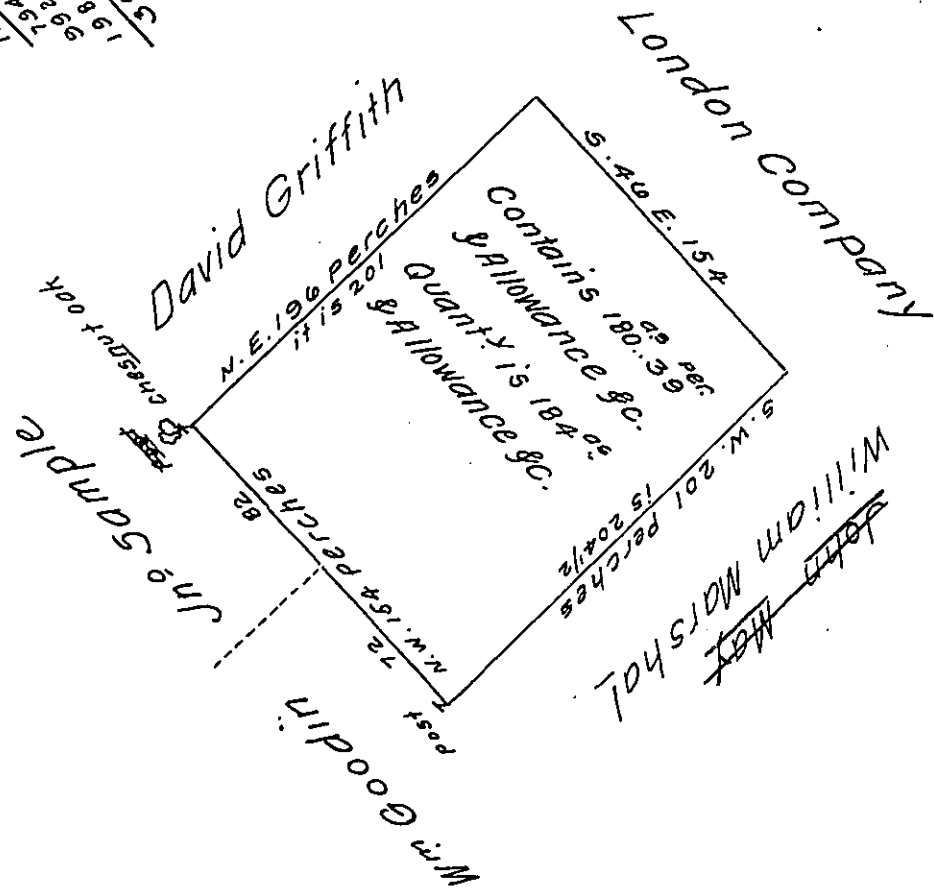

By virtue of a Warr<sup>t</sup> from the Hon<sup>ble</sup> the Proprietaries dated — the — day of — 1738. Surveyed to John May the above discribed peice of Land. Situate in the County of Bucks. being part of a Tract of Land called Streepers tract. Containing 183<sup>2</sup>/<sub>3</sub> with Allowance of Six & Cent.

Nich<sup>o</sup> Scull. —

Enquire of Nich<sup>o</sup> Scull if there be no mistake in the length of the lines as here described.

IN TESTIMONY that the above is a copy of the original remaining on file in the Department of Internal Affairs of Pennsylvania, made conformably to an Act of Assembly approved the 16th day of February, 1833, I have hereunto set my Hand and caused the Seal of said Department to be affixed at Harrisburg, this seventeenth day of June 1910.

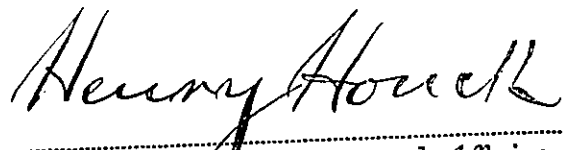
  
 Secretary of Internal Affairs.